

Actuated Butterfly and Ball Valve Manual Override



General

- **Actuator:** Electric, pneumatic
- **Butterfly Valve Size:** 2"–8"
- **Ball Valve Size:** 2½"–4"
- **Coupling Material:** Stainless steel
- **Lever Material:** Steel
- **Adapter Coating:** Nickel plated steel
- **Hardware:** Inclusive
- **Hardware Material:** Stainless steel
- **Mounting:** ISO 5211
- **Standard Pack Quantity:** 1 piece

Standard Assemblies

Of the valve types detailed in this document as compatible with the manual override, only the electrically actuated ball valve family offers standard assemblies that include the manual override, however one can be added as an accessory to all other listed standard assembly types.

Sample Specification

GF's Actuated Butterfly and Ball Valve Manual Override shall be declutchable in design and utilized with a butterfly or ball valve assembly with a 90 degree stroke. The adapter assembly shall utilize two drives, one male drive shall adapt to the actuator and one female drive shall adapt to the valve. The adapter handle attachment shall declutch the two drives when an operator applies pressure to the handle allowing for the manual override function. Required hardware for mounting to a GF valve and actuator shall be inclusive. The handle shall not be mechanically joined to the adapter while in service and secured in provided clips while not in service. All manual overrides shall be manufactured under ISO9001 for Quality and ISO14001 for Environmental Management.

Components

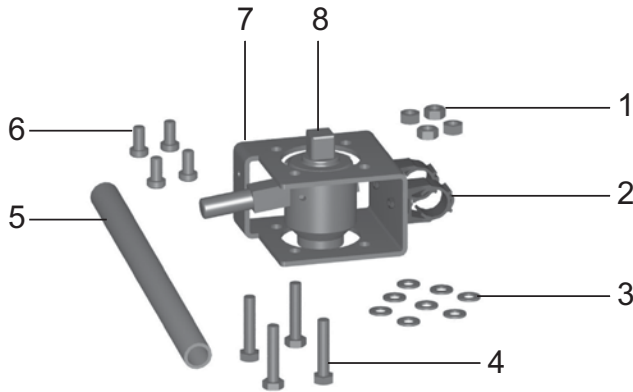

Components

| Part | Description | Material |
|------|---------------------|---------------------|
| 1 | Valve side nuts | 304 Stainless steel |
| 2 | Handle clips | PP |
| 3 | Valve side washers | 304 Stainless steel |
| 4 | Valve side bolts | 304 Stainless steel |
| 5 | Handle | Epoxy coated steel |
| 6 | Actuator side bolts | 304 Stainless steel |
| 7 | Housing | Epoxy coated steel |
| 8 | Adapter | Nickel plated steel |



Compatibility

Butterfly Valves

| Size (inch) | Type | Action | Actuator | Part Number | Female (mm) | Male (mm) |
|-------------|------|--------|----------|-------------|-------------|-----------|
| 2 | PA | FC/FO | PA30 | 198000630 | 11 | 11 |
| 2½ | PA | FC/FO | PA30 | 198000630 | 11 | 11 |
| 3 | PA | FC/FO | PA35 | 198000631 | 11 | 14 |
| 4 | PA | FC/FO | PA40 | 198000628 | 14 | 14 |
| 5 | PA | FC/FO | PA45 | 198000629 | 14 | 17 |
| 6 | PA | FC/FO | PA50 | 198000625 | 17 | 17 |
| 8 | PA | FC/FO | PA55 | 198000627 | 17 | 22 |
| 2 | PA | DA | PA35 | 198000630 | 11 | 11 |
| 2½ | PA | DA | PA35 | 198000630 | 11 | 11 |
| 3 | PA | DA | PA40 | 198000630 | 11 | 11 |
| 4 | PA | DA | PA45 | 198000628 | 14 | 14 |
| 5 | PA | DA | PA45 | 198000628 | 14 | 14 |
| 6 | PA | DA | PA55 | 198000625 | 17 | 17 |
| 8 | PA | DA | PA55 | 198000625 | 17 | 17 |
| 2 | EA | - | EA120 | 198000623 | 11 | 17 |
| 2½ | EA | - | EA120 | 198000623 | 11 | 17 |
| 3 | EA | - | EA120 | 198000623 | 11 | 17 |
| 4 | EA | - | EA120 | 198000624 | 14 | 17 |
| 5 | EA | - | EA120 | 198000624 | 14 | 17 |
| 6 | EA | - | EA120 | 198000625 | 17 | 17 |
| 8 | EA | - | EA250 | 198000627 | 17 | 22 |

Ball Valves

| Size (inch) | Type | Action | Actuator | Part Number | Female (mm) | Male (mm) |
|-------------|------|--------|----------|-------------|-------------|-----------|
| 2½ | PA | FC/FO | PA30 | 198000630 | 11 | 11 |
| 3 | PA | FC/FO | PA40 | 198000631 | 11 | 14 |
| 4 | PA | FC/FO | PA40 | 198000628 | 14 | 14 |
| 2½ | PA | DA | PA35 | 198000630 | 11 | 11 |
| 3 | PA | DA | PA40 | 198000630 | 11 | 11 |
| 4 | PA | DA | PA45 | 198000628 | 14 | 14 |
| 2½ | EA | - | EA120 | 198000623 | 11 | 17 |
| 3 | EA | - | EA120 | 198000623 | 11 | 17 |
| 4 | EA | - | EA120 | 198000624 | 14 | 17 |

